

Abbott & Abbott

Estate Agents, Valuers and Lettings



Flat 2 Bedford Lodge Cantelupe Road, Bexhill On Sea, TN40

£155,000

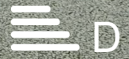



£155,000

Flat 2 Bedford Lodge Cantelupe Road

Bexhill On Sea, TN40 1PR

- GROUND FLOOR FLAT
- ONE BEDROOM
- GAS HEATING
- CLOSE TOWN CENTRE
- STATION NEARBY
- GARDEN
- NO CHAIN
- DOUBLE GLAZING
- JUST OFF SEAFRONT
- IDEAL BUY TO LET

Abbott and Abbott are delighted to offer for sale this converted ground floor Garden flat located in a convenient position just off the seafront, close to the town centre and station.

The property is being sold chain free and has double glazing/ electric heating.

Ideal first time buyer or buy to let

Accommodation comprises of Hall, Living room, Open plan kitchen, Bedroom, Shower room, Garden



ENTRANCE HALL

LIVING ROOM

11'5" x 9'2" (3.5 x 2.8)

KITCHEN

7'6" x 5'6" (2.3 x 1.7)

BEDROOM

12'5" x 11'9" (3.8 x 3.6)

SHOWER ROOM

GARDEN

LEASE - NEW 999 YEARS

GROUND RENT - PEPPERCORN

SERVICE CHARGE - £400 PA APPROX

TENURE - SHARE OF FREEHOLD



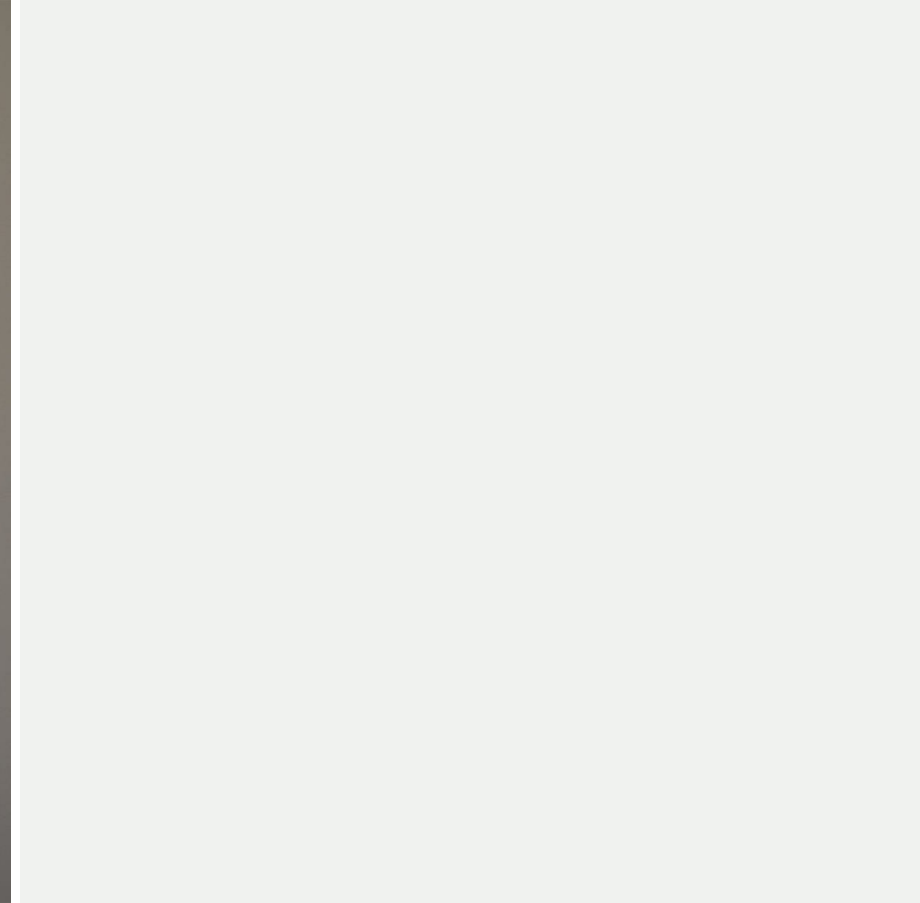



Floor Plans

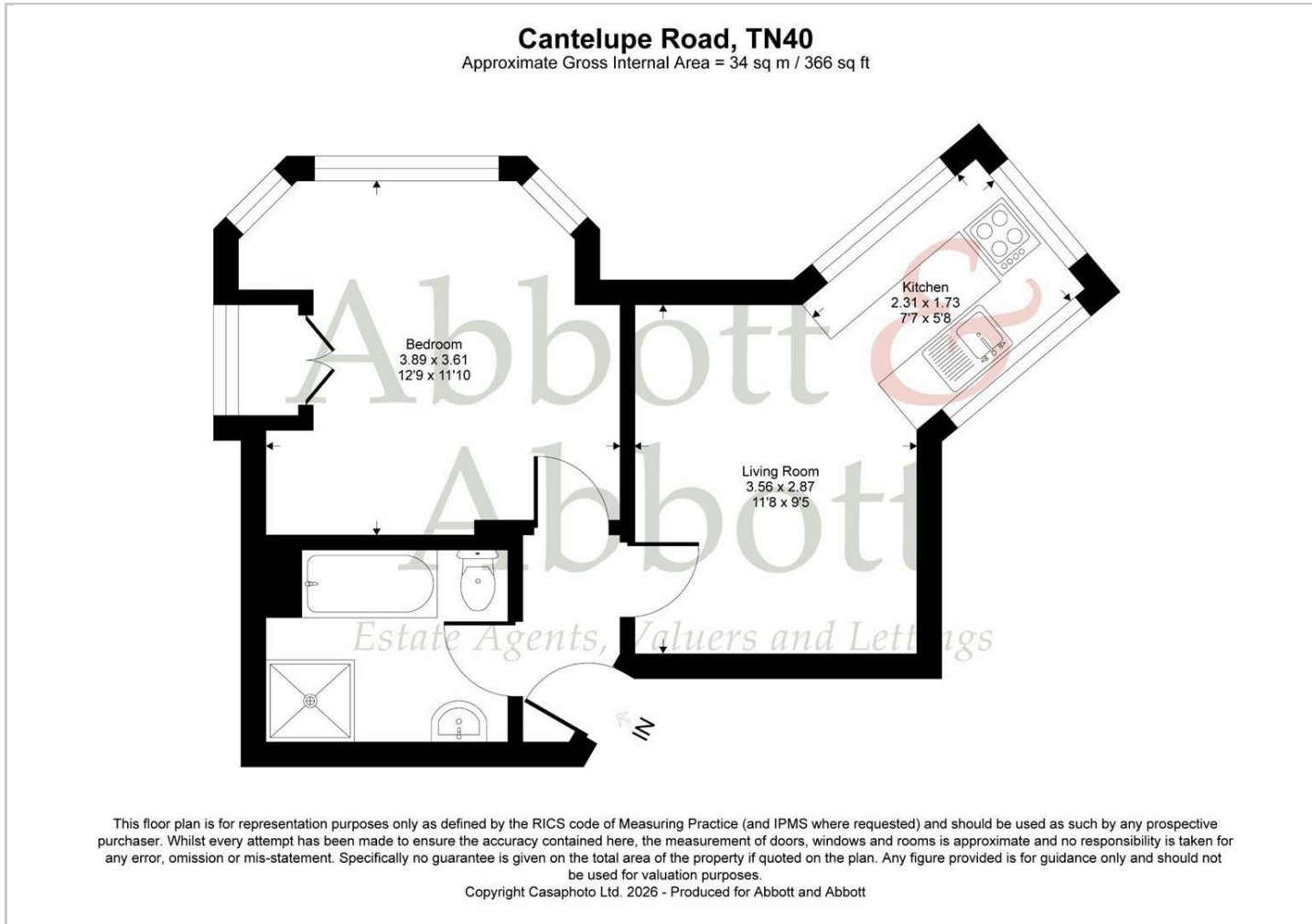

Viewing

Please contact our Sales Office on 01424 212233 if you wish to arrange a viewing appointment for this property or require further information.

The particulars are set out as a general outline only for the guidance of intended purchasers or lessees, and do not constitute, any part of a contract. Nothing in these particulars shall be deemed to be a statement that the property is in good structural condition or otherwise nor that any of the services, appliances, equipment or facilities are in good working order. Purchasers should satisfy themselves of this prior to purchasing.

25 Devonshire Road, Bexhill On Sea, East Sussex, TN40 1AH
Tel: 01424 212233 Email: sales@abbottandabbott.co.uk

Location Map

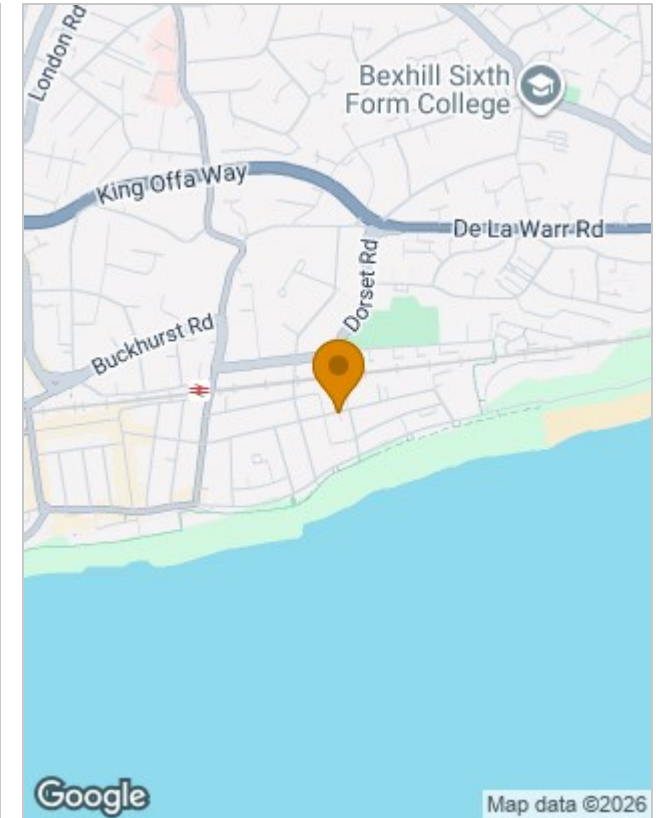

Energy Performance Graph

